

Accessing CAMPUS via the Parent Portal

If you have questions, please contact the Parent Helpline at: (952) 975-7094

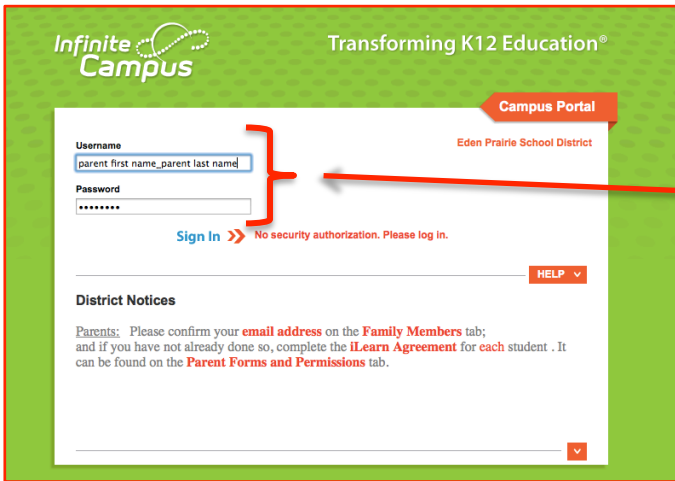

Go to www.edenpr.org
Click on **LOGIN**
Then, click on **Parent Portal**



Type in your **Username** and **Password**
(this information is provided by the school)

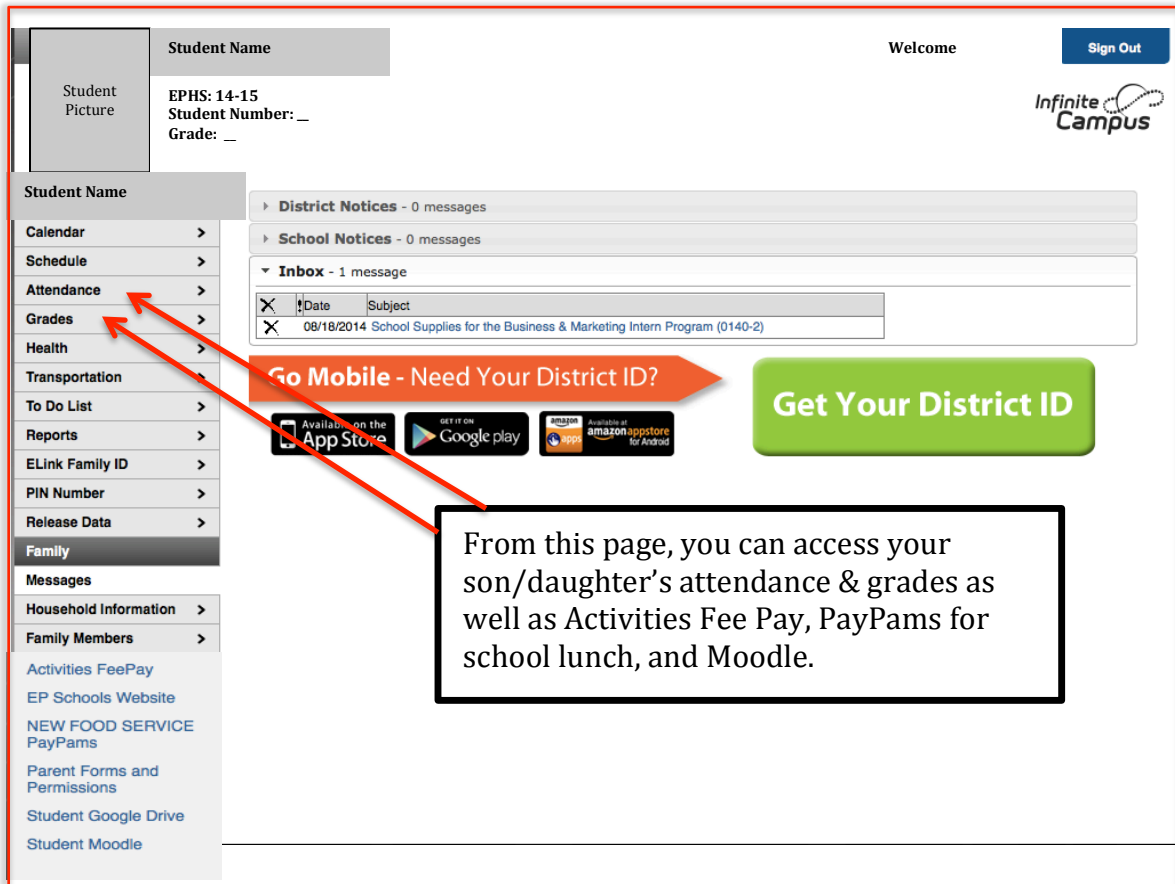

From this page, you can access your son/daughter's attendance & grades as well as Activities Fee Pay, PayPams for school lunch, and Moodle.

Grades:

Grades

Recently Graded Assignments

Posted	Course	Assignment	Score	Total	Percent
27 minutes ago	0626 - College Prep Algebra B	chapter 11 test	44	44	100%
12 hours ago	3140 - Bus Seminar T2	Application Letter	27	30	90%
3 days ago	3140 - Bus Seminar T2	Final Interview	100	100	100%
3 days ago	0626 - College Prep Algebra B	chapter 11 review	4	4	100%
3 days ago	0626 - College Prep Algebra B	review worksheet	4	4	100%

Grades By Course

Expand All Collapse All In-Progress Grade Final Grade

- 3140-2 Bus Seminar T2 - Brettingen, Karen L. Term Grade: 1 2 3 4 (88.21% B+)
- 0140-2 Bus Seminar/T1 - Brettingen, Karen L. Term Grade: 1 2 3 4 (96.66% A)
- 1141-4 BusMkt Internship - Streich, Shelly Term Grade: 1 2 3 4

Click on the class link to see assessment/assignment detail.

Email addresses for teachers : first initial and then last name followed by edenpr.org
Ex) sstreich@edenpr.org

Attendance:

Attendance

November 2014 December 2014 January 2015

Su Mo Tu We Th Fr Sa Su Mo Tu We Th Fr Sa Su Mo Tu We Th Fr Sa

Dates that are highlighted can be clicked to view daily period details. Excused Unexcused Exempt Unknown

Attendance Summary by Course

Course	Teacher	Periods Absent	Tardy	Early Release
C024 Conn:Murq - Norb	Boyd, Jill	1	1	0

If your son/daughter is absent because of:

- Illness
- A doctor appointment
- A family emergency
- Religious observance
- Or Weather

Please call our attendance line at: (952) 975-8001